

Covid-19 Test Regulations for Passengers bound for China Mainland

- **2x Covid-19 tests** (PCR and IgM antibody within 48 h before departure) plus a **Green HS Code** (Chinese Citizens) or a **Green HDC Code** (Non-Chinese Citizens) are required by Chinese authorities to board the aircraft bound for China Mainland.
- In addition, a **Red Chinese Customs Entry/Exit Health Code** (at the day of departure) is required to **board and deboard** the aircraft.
- In case of a **cross-border feeder** flight, the passenger must obtain the 2x Covid-19 tests and apply for the Green HS code or HDC code **in BOTH countries**.
- In case of a **domestic feeder** flight, the passenger can obtain the Covid-19 test in the origin city or at the respective Covid-19 test center at the airport.

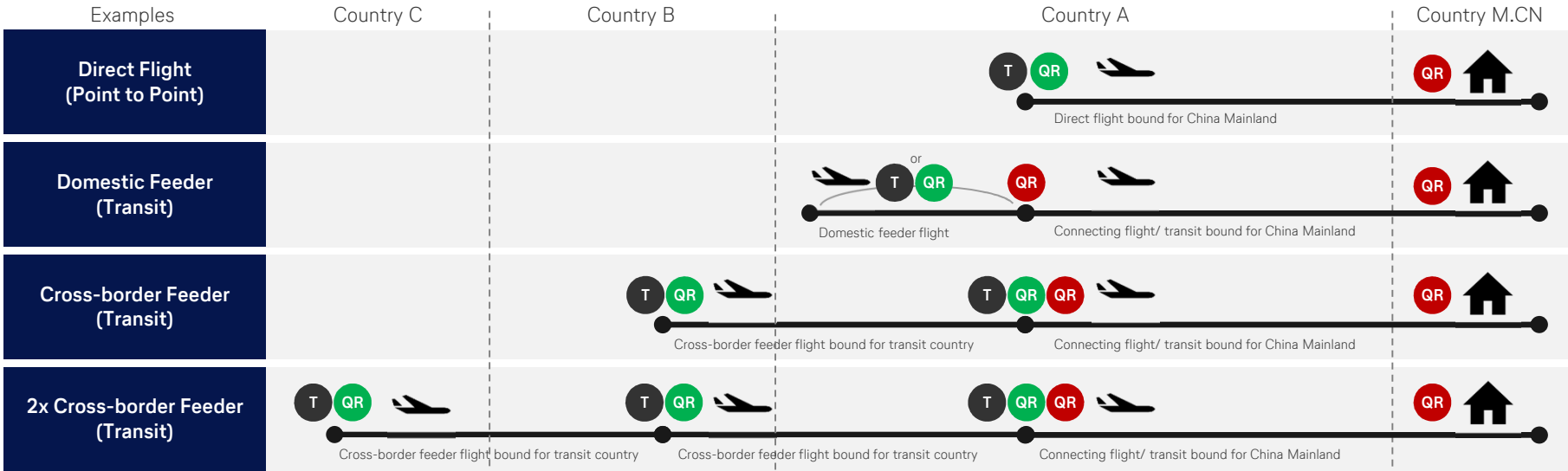

T Obtain a 1x PCR and 1x IgM Tests 48hours before departure.
 QR Apply for and obtain a Green HS Code (Chinese Citizens) or Green HDC Code (Non-Chinese Citizens).
 QR Obtain a Red Customs Entry/ Exit Health Code at the day of departure of the long-haul flight bound for China Mainland (24h validity).



Three Covid-19 test centers at FRA offer a PCR and IgM antibody test which allows a smooth transit (within 8h, without overnight stay) to China Mainland.

Attn: Passengers originating from “areas of variant of concern” defined by RKI – currently BR, ZA, UK, IE, PT - are not allowed to transfer in FRA

Details

1 Covid-19 Test Center - Medical Center

Hours: Mon. – Sun. 07:00 – 16:00
 Offered Tests: ✗ PCR ✓ IgM antibody (110~123EUR)
 Transit Type: ✓ Domestic Passenger
 ✓ Schengen Passenger
 ✗ Non-Schengen Passenger



2 Covid-19 Test Center - Centogene Sqaire

Hours: Mon. – Sun. 06:00 – 19:00
 Offered Tests: ✓ PCR (148EUR) ✗ IgM antibody
 Transit Type: ✓ Domestic Passenger
 ✓ Schengen Passenger
 ✗ Non-Schengen Passenger



3 Covid-19 Test Center - Transit Area Non-Schengen

Hours: Sun. – Wed. 11:00 – 14:00
 Offered Tests: ✓ PCR (179EUR) ✓ IgM antibody (129~149EUR)
 Transit Type: ✗ Domestic Passenger
 ✗ Schengen Passenger
 ✓ Non-Schengen Passenger



<https://www.lufthansa.com/cn/en/local-page/china-flight-schedule>

Covid-19 Test Facilities at Frankfurt Airport



- Test center in the transit area are **only available for Lufthansa transit passengers** who hold **1 ticket** for the whole journey, including a LH operated flight bound for China Mainland on a **LH flight number** (LH720, LH728, LH780). Test center in the transit area is not available for a CA, CZ, DE, MU operating flight.
- Covid-19 tests** (PCR and IgM antibody) **need to be pre-booked**.
- In case of a transit, passenger **needs to present a Green HS Code** (Chinese Citizens) **or a Green HDC Code** (Non-Chinese Citizens) **of the inbound/ origin county** to obtain the Covid-19 tests in the transit area at Frankfurt airport.

One Covid-19 test center at VIE offers a PCR and IgM antibody test which allows a smooth transit (within 9h, without overnight stay) to China Mainland.

Details

Covid-19 Test Center – Gate G11

Level 3 – G Gates | next to Service Center

Hours: Fri. 11:00 – 13:30

Offered Tests: ✓ PCR ✓ IgM antibody (2 tests totally 160 EUR)

Transit Type: ✓ Schengen Passenger
✓ Non-Schengen Passenger

- Test center in the transit area are **only available for Austrian transit passengers** on a OS operated flight bound for China Mainland.
- No pre-registration necessary to obtain the Covid-19 tests, just **walk-in**. The test center accepts **credit card** payment (Mastercard, Visa, Diners Club) only.
- In case of a transit, passenger **needs to present a Green HS Code** (Chinese Citizens) **or a Green HDC Code** (Non-Chinese Citizens) **of the inbound/ origin county** to obtain the Covid-19 tests in the transit area at Vienna airport.

<https://www.austrian.com/cn/en/china-flight-schedule>

Test Facilities at Vienna Airport

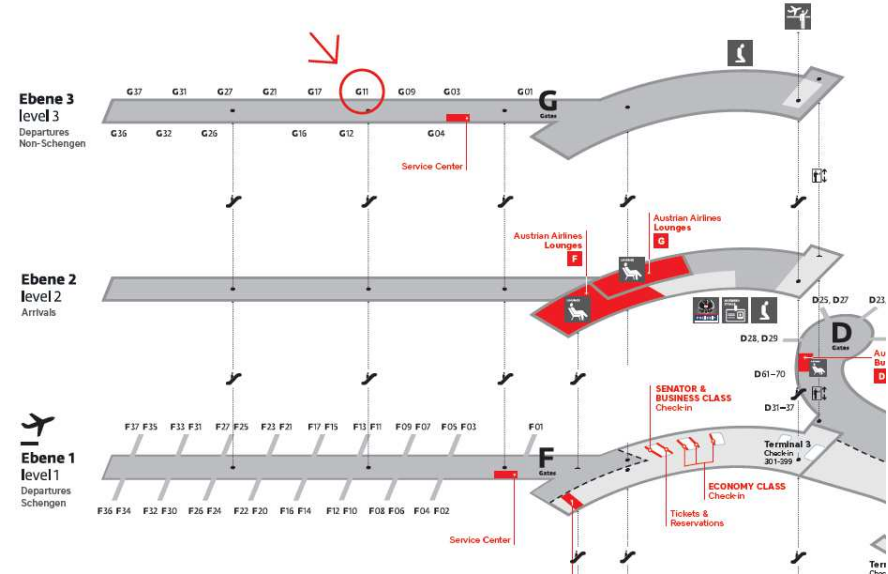

One Covid-19 test center at ZRH offers a PCR and IgM antibody test which allows a smooth transit (within 8h, without overnight stay) to China Mainland.

Details

Covid-19 Test Center – SWISS Business Lounge D

Business Lounge D, Non-Schengen Departure Area

Hours: Sun. 10:00-14:00

Offered Tests: ✓ PCR ✓ IgM antibody (2 tests totally 340 CHF)

Transit Type: ✓ Schengen Passenger
✓ Non-Schengen Passenger

- Test center in the transit area are **only available for SWISS transit passengers** on a LX operated flight bound for China Mainland.
- No pre-registration necessary to obtain the Covid-19 tests, just **walk-in**. The test center accepts **credit card** payment (Visa, MasterCard, Maestro) only.
- In case of a transit, passenger **needs to present a negative PCR and IgM test certificate issued from the inbound/ origin county** to obtain the Covid-19 tests in the transit area at Zurich airport.

<https://www.swiss.com/china/en/china-flight-schedule>

Test Facilities at Zurich Airport

Business Lounge D

